

APPROVAL

TO: Etex Telephone Coop., Inc.
P.O. Box 130 Gilmer, TX 75644

DATE 03-23-26

The Upshur County Commissioners Court offers no objections to the location on the right-of-way of your proposed New Fiber Optic line across PIGEON RD AND SIKTREE RD., as shown by accompanying drawings and notice dated Approved, except as noted below:

N/A

It is expressly understood that the Upshur County Commissioners Court does not purport, hereby, to grant and right, claim, title, or easement in or upon this county road; and it is further understood that in the future should for any reason Upshur County need to work, improve, relocate, widen, increase add to or any manner change the structure of this right-of-way line, this line, if affected, will be moved under the direction of the Upshur County Engineer and shall be relocated at the complete expense of the owner. Upshur County shall be notified a minimum of 48 hours prior to the beginning of any work.

All work on the county right-of-way shall be performed in accordance with the County Engineer's instructions. The installation shall not damage any part of the highway and adequate provisions must be made to cause minimum inconvenience to traffic and adjacent property owners. Special specifications for placing this line are as follows:

1. All ground lines are to be installed a minimum of 36 inches below the flowline of the adjacent drainage or borrow ditch.
2. All excavations within the right-of-way and not under surfacing shall be backfilled by tamping in 6 inch horizontal layers. All surplus material shall be removed from the right-of-way and the excavation finished flush with surrounding natural ground.
3. Lines crossing under surfaced roads and under surfaced cross roads within the right-of-way shall be placed by boring. Boring shall extend from crown line to crown line.
4. All lines under roads carrying pressure in excess of 50 psi shall be enclosed in satisfactory casing extending from right-of-way line to right-of-way line. Pipe used for casing may be of any type approved by the County Engineer and shall be capable of Supporting the load of roadbed and traffic and shall be so constructed that there will be no leakage of any matter through the casing for its entire length. Inside diameter of casing shall be at least 2 inches greater than the largest outside diameter of carrier pipe, joint or couplings. (Encasement is not required on lines installed 48 inches or greater below flowline.)
5. All lines, where practicable, shall be located to cross roadbed at approximately right angles thereto. No lines are to be installed under or within 50 feet of either end of a bridge unless approved by the County Engineer in writing. No lines shall be placed inside any culvert or within 10 feet of the closest point of same.
6. Parallel lines will be installed as near the right-of-way lines as is possible and no parallel line will be installed in the roadbed or between the drainage ditch and roadbed unless approved by the County Engineer in writing.
7. Overhead lines will have a minimum clearance of 18 feet above the road surface at point of crossing.
8. Operations along roadways shall be performed in such a manner that all excavated material be kept off the pavements at all times, as well as all operating equipment and materials. Do not use equipment or installation procedures which will damage any road surface or structure. The cost of any repairs to road surfaces, roadbed, structures or other right-of-way features as direct result of this installation will be borne by the owner of this line.
9. Barricades, warning signs, lights and flagmen, when necessary, shall be provided by the contractor or owner. One half of the traveled portion of the road must be open to traffic at all times. All traffic control shall be in accordance with the requirements of the current version of the Texas MUTCD.
10. Utility company shall install adequate erosion control measures for any excavation work being performed.

APPROVED: 
Road Administrator

APPROVED: _____
Chairperson, Upshur County Commissioners Court

NOTICE OF PROPOSED INSTALLATION

NOTICE OF PROPOSED INSTALLATION
PIPE AND/OR UTILITY LINES

DATE: 03/23/2026

TO: UPSHUR COUNTY COMMISSIONERS COURT
c/o UPSHUR COUNTY ENGINEER
UPSHUR COUNTY ROAD & BRIDGE DEPARTMENT
P. O. BOX 730
Gilmer, TX 75644

EXPIRES: 11/23/2026

Formal notice is hereby given that Etex Telephone Coop., Inc. proposes to bore a New Fiber Optic line within the right-of-way of County Roads PIGEON RD AND SILK TREE RD., as follows: Installing new fiber and duct on both sides of said county roads. All construction will be directionally bored at a min depth of 60" within the Upshur county Road and Bridge right-of-way.

The location and description of the proposed line and appurtenances is more fully shown by three copies of drawings attached to this notice. The line will be constructed and maintained on the County right-of-way as directed by the County Engineer in accordance with current Upshur County specifications.

Construction of this line will begin on or after the 1ST day of April, 2026 and will be completed within 120 days of the date of approval.

Firm Etex Telephone Coop., Inc.
By JASON ALLEN
Title PLANT ENGINEER
Address P.O. Box 130 Gilmer, TX 75644

- NOTE:
1. This form to be submitted in triplicate for each proposed installation.
 2. The permit shall be in effect until the utility line is removed from the right of way.
 3. Inform the County Engineer if work is not completed within this time

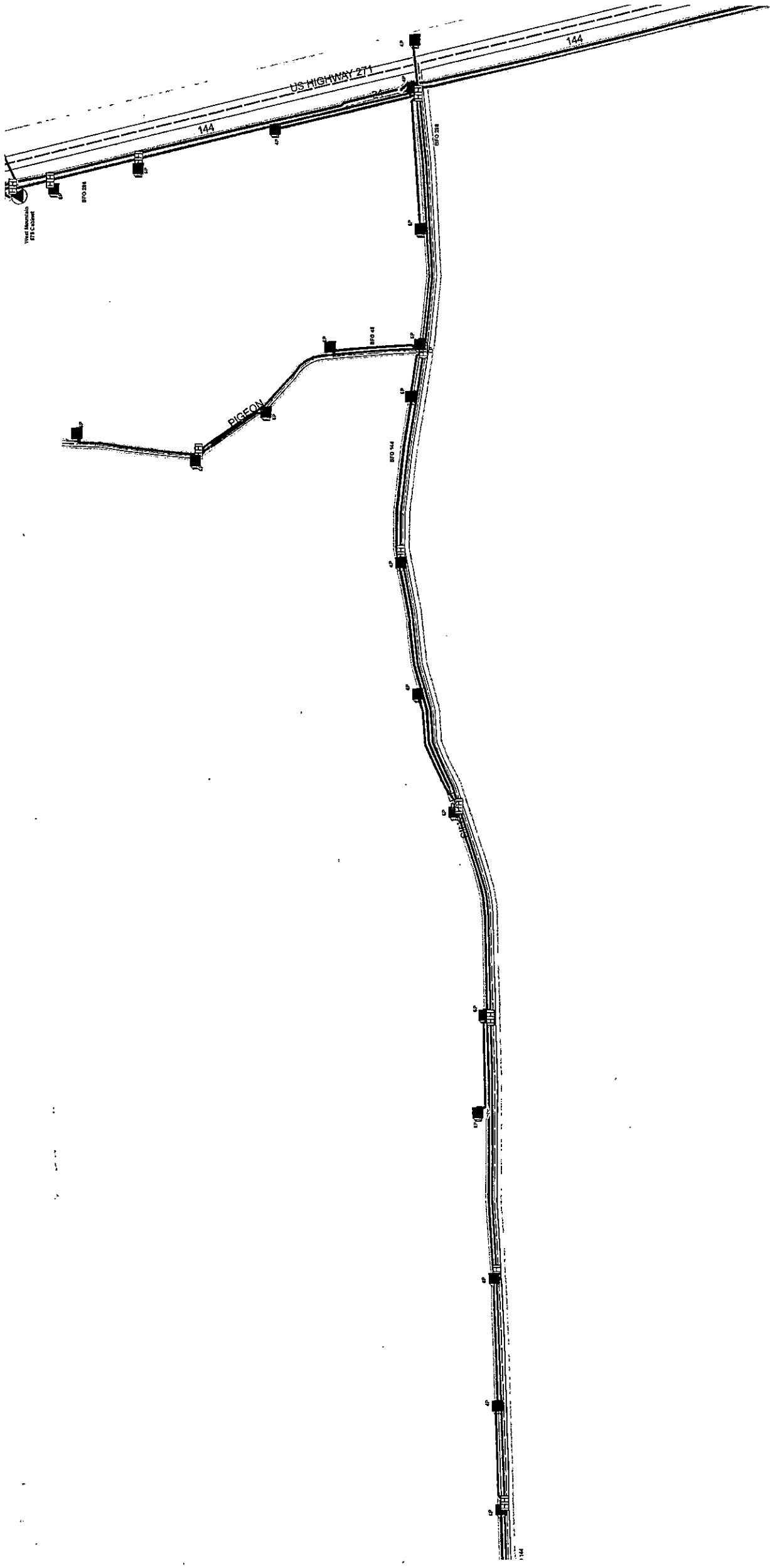

DRIVEWAY PERMIT APPLICATION

TO: THE UPSHUR COUNTY COMMISSIONERS COURT
COUNTY OF UPSHUR
GILMER, TEXAS

PRECINCT 3

DATE March 19, 2026

Formal notice is hereby given that Dwight Clark, whose principal address is 5273 Aspen Trl, does hereby propose to place a driveway culvert within the ROW of County Road Aspen. Proposed construction will begin, if approved, on or after the 31st day of March, 20 26. I, Dwight Clark, hereby attest that I have read the conditions set forth in this application and understand its contents. The culvert X will/___ will not be placed by County equipment and personnel. This is a X new installation ___ extension.

SIGNATURE: Dwight Clark

TELEPHONE: 903-932-3402

APPROVAL OF PERMIT APPLICATION

The Upshur County Commissioners Court offers no objection to the location on the right of way of your proposed driveway culvert for the address shown above. The proposed driveway structure will be a 12 "x24" culvert.

Recommended by Phil [Signature]

APPROVED ON THIS 3 DAY OF 19, 2026

APPROVAL

TO: Etex Telephone Coop., Inc.
P.O. Box 130 Gilmer, TX 75644

DATE 03/18/2026

The Upshur County Commissioners Court offers no objections to the location on the right-of-way of your proposed New Fiber Optic line across THRUSH RD, PHEASANT EAST, PHEASANT WEST, BOB O LINK NORTH, BOB O LINK SOUTH BAILEY RD, as shown by accompanying drawings and notice dated Approved, except as noted below:

N/A

It is expressly understood that the Upshur County Commissioners Court does not purport, hereby, to grant and right, claim, title, or easement in or upon this county road; and it is further understood that in the future should for any reason Upshur County need to work, improve, relocate, widen, increase add to or any manner change the structure of this right-of-way line, this line, if affected, will be moved under the direction of the Upshur County Engineer and shall be relocated at the complete expense of the owner. Upshur County shall be notified a minimum of 48 hours prior to the beginning of any work.

All work on the county right-of-way shall be performed in accordance with the County Engineer's instructions. The installation shall not damage any part of the highway and adequate provisions must be made to cause minimum inconvenience to traffic and adjacent property owners. Special specifications for placing this line are as follows:

1. All ground lines are to be installed a minimum of 36 inches below the flowline of the adjacent drainage or borrow ditch.
2. All excavations within the right-of-way and not under surfacing shall be backfilled by tamping in 6 inch horizontal layers. All surplus material shall be removed from the right-of-way and the excavation finished flush with surrounding natural ground.
3. Lines crossing under surfaced roads and under surfaced cross roads within the right-of-way shall be placed by boring. Boring shall extend from crown line to crown line.
4. All lines under roads carrying pressure in excess of 50 psi shall be enclosed in satisfactory casing extending from right-of-way line to right-of-way line. Pipe used for casing may be of any type approved by the County Engineer and shall be capable of Supporting the load of roadbed and traffic and shall be so constructed that there will be no leakage of any matter through the casing for its entire length. Inside diameter of casing shall be at least 2 inches greater than the largest outside diameter of carrier pipe, joint or couplings. (Encasement is not required on lines installed 48 inches or greater below flowline.)
5. All lines, where practicable, shall be located to cross roadbed at approximately right angles thereto. No lines are to be installed under or within 50 feet of either end of a bridge unless approved by the County Engineer in writing; No lines shall be placed inside any culvert or within 10 feet of the closest point of same.
6. Parallel lines will be installed as near the right-of-way lines as is possible and no parallel line will be installed in the roadbed or between the drainage ditch and roadbed unless approved by the County Engineer in writing.
7. Overhead lines will have a minimum clearance of 18 feet above the road surface at point of crossing.
8. Operations along roadways shall be performed in such a manner that all excavated material be kept off the pavements at all times, as well as all operating equipment and materials. Do not use equipment or installation procedures which will damage any road surface or structure. The cost of any repairs to road surfaces, roadbed, structures or other right-of-way features as direct result of this installation will be borne by the owner of this line.
9. Barricades, warning signs, lights and flagmen, when necessary, shall be provided by the contractor or owner. One half of the traveled portion of the road must be open to traffic at all times. All traffic control shall be in accordance with the requirements of the current version of the Texas MUTCD.
10. Utility company shall install adequate erosion control measures for any excavation work being performed.

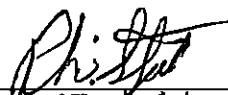
APPROVED: 
Road Administrator

APPROVED: _____
Chairperson, Upshur County Commissioners Court

NOTICE OF PROPOSED INSTALLATION

NOTICE OF PROPOSED INSTALLATION
PIPE AND/OR UTILITY LINES

DATE: 03/18/2026

TO: UPSHUR COUNTY COMMISSIONERS COURT
c/o UPSHUR COUNTY ENGINEER
UPSHUR COUNTY ROAD & BRIDGE DEPARTMENT
P. O. BOX 730
Gilmer, TX 75644

EXPIRES: 08/01/2026

Formal notice is hereby given that Etex Telephone Coop., Inc. proposes to bore a New Fiber Optic line within the right-of-way of County Roads THRUSH RD, PHEASANT EAST, PHEASANT WEST, BOB O LINK SOUTH, BOB O LINK NORTH, AND BAILEY RD, as follows: Installing new fiber and duct on both sides of said county roads. All construction will be directionally bored at a min depth of 60" within the Upshur county Road and Bridge right-of-way.

The location and description of the proposed line and appurtenances is more fully shown by three copies of drawings attached to this notice. The line will be constructed and maintained on the County right-of-way as directed by the County Engineer in accordance with current Upshur County specifications.

Construction of this line will begin on or after the 17th day of April, 2023 and will be completed within 120 days of the date of approval.

Firm Etex Telephone Coop., Inc.
By JASON ALLEN
Title PLANT ENGINEER
Address P.O. Box 130 Gilmer, TX 75644

- NOTE: 1. This form to be submitted in triplicate for each proposed installation.
2. The permit shall be in effect until the utility line is removed from the right of way.
3. Inform the County Engineer if work is not completed within this time

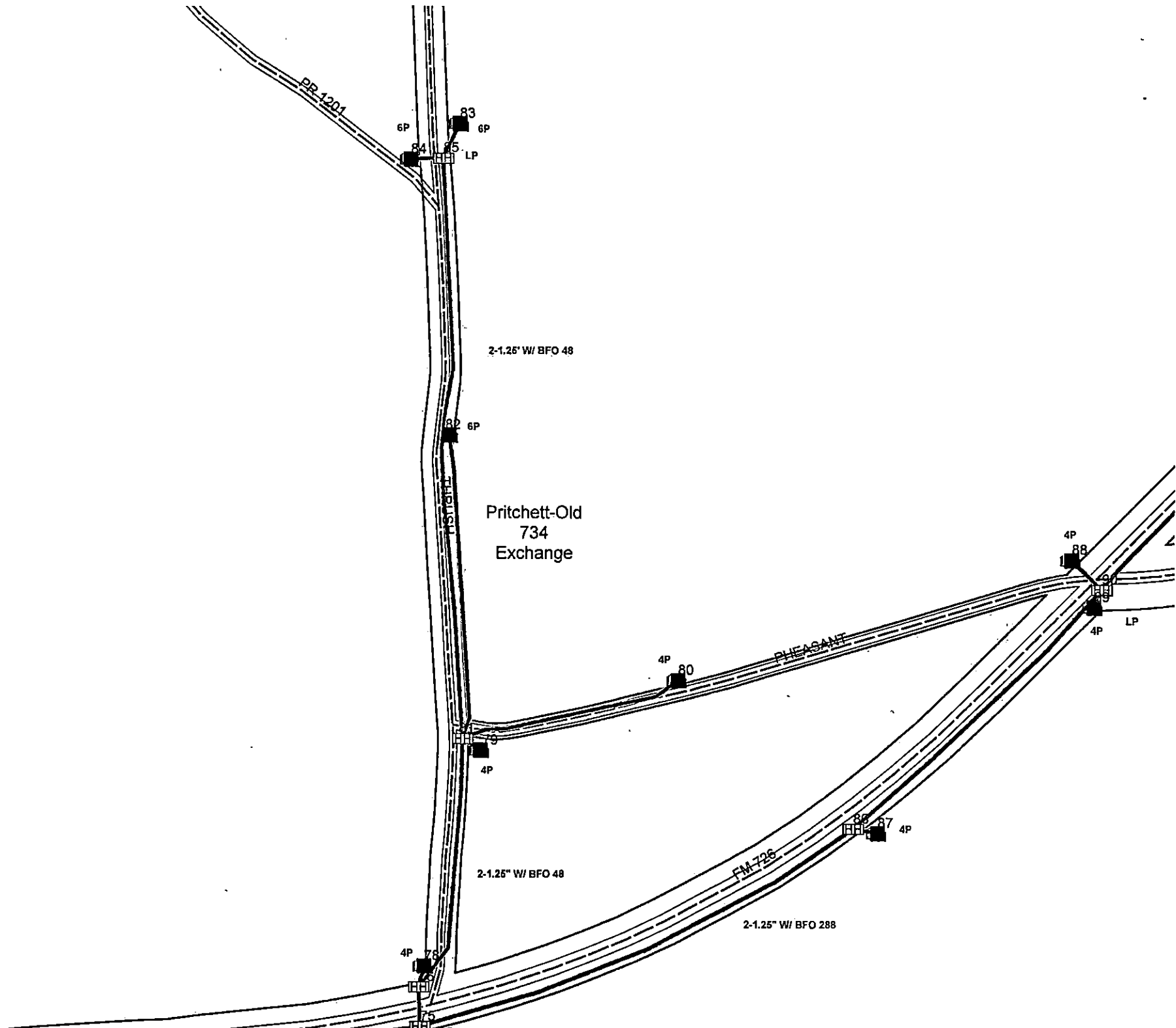

Pritchett-Old
734
Exchange

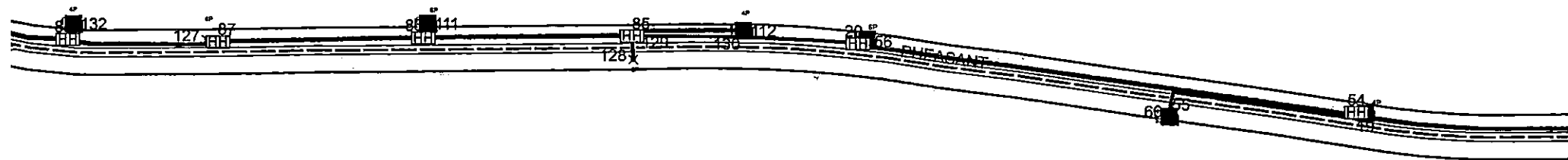

APPROVAL

TO: Etex Telephone Coop., Inc.
P.O. Box 130 Gilmer, TX 75644

DATE 03/18/2026

The Upshur County Commissioners Court offers no objections to the location on the right-of-way of your proposed New Fiber Optic line across SMITH RD AND SHORT RD, as shown by accompanying drawings and notice dated Approved, except as noted below:

N/A

It is expressly understood that the Upshur County Commissioners Court does not purport, hereby, to grant and right, claim, title, or easement in or upon this county road; and it is further understood that in the future should for any reason Upshur County need to work, improve, relocate, widen, increase add to or any manner change the structure of this right-of-way line, this line, if affected, will be moved under the direction of the Upshur County Engineer and shall be relocated at the complete expense of the owner. Upshur County shall be notified a minimum of 48 hours prior to the beginning of any work.

All work on the county right-of-way shall be performed in accordance with the County Engineer's instructions. The installation shall not damage any part of the highway and adequate provisions must be made to cause minimum inconvenience to traffic and adjacent property owners. Special specifications for placing this line are as follows:

1. All ground lines are to be installed a minimum of 36 inches below the flowline of the adjacent drainage or borrow ditch.
2. All excavations within the right-of-way and not under surfacing shall be backfilled by tamping in 6 inch horizontal layers. All surplus material shall be removed from the right-of-way and the excavation finished flush with surrounding natural ground.
3. Lines crossing under surfaced roads and under surfaced cross roads within the right-of-way shall be placed by boring. Boring shall extend from crown line to crown line.
4. All lines under roads carrying pressure in excess of 50 psi shall be enclosed in satisfactory casing extending from right-of-way line to right-of-way line. Pipe used for casing may be of any type approved by the County Engineer and shall be capable of Supporting the load of roadbed and traffic and shall be so constructed that there will be no leakage of any matter through the casing for its entire length. Inside diameter of casing shall be at least 2 inches greater than the largest outside diameter of carrier pipe, joint or couplings. (Encasement is not required on lines installed 48 inches or greater below flowline.)
5. All lines, where practicable, shall be located to cross roadbed at approximately right angles thereto. No lines are to be installed under or within 50 feet of either end of a bridge unless approved by the County Engineer in writing. No lines shall be placed inside any culvert or within 10 feet of the closest point of same.
6. Parallel lines will be installed as near the right-of-way lines as is possible and no parallel line will be installed in the roadbed or between the drainage ditch and roadbed unless approved by the County Engineer in writing.
7. Overhead lines will have a minimum clearance of 18 feet above the road surface at point of crossing.
8. Operations along roadways shall be performed in such a manner that all excavated material be kept off the pavements at all times, as well as all operating equipment and materials. Do not use equipment or installation procedures which will damage any road surface or structure. The cost of any repairs to road surfaces, roadbed, structures or other right-of-way features as direct result of this installation will be borne by the owner of this line.
9. Barricades, warning signs, lights and flagmen, when necessary, shall be provided by the contractor or owner. One half of the traveled portion of the road must be open to traffic at all times. All traffic control shall be in accordance with the requirements of the current version of the Texas MUTCD.
10. Utility company shall install adequate erosion control measures for any excavation work being performed.

APPROVED: 
Road Administrator

APPROVED: _____
Chairperson, Upshur County Commissioners Court

NOTICE OF PROPOSED INSTALLATION

NOTICE OF PROPOSED INSTALLATION
PIPE AND/OR UTILITY LINES

DATE: 03/18/2026

TO: UPSHUR COUNTY COMMISSIONERS COURT
c/o UPSHUR COUNTY ENGINEER
UPSHUR COUNTY ROAD & BRIDGE DEPARTMENT
P. O. BOX 730
Gilmer, TX 75644

EXPIRES: 0801/2026

Formal notice is hereby given that Etex Telephone Coop., Inc. proposes to bore a New Fiber Optic line within the right-of-way of County Roads SMITH RD AND SHORT RD, as follows: Installing new fiber and duct on both sides of said county roads. All construction will be directionally bored at a min depth of 60" within the Upshur county Road and Bridge right-of-way.

The location and description of the proposed line and appurtenances is more fully shown by three copies of drawings attached to this notice. The line will be constructed and maintained on the County right-of-way as directed by the County Engineer in accordance with current Upshur County specifications.

Construction of this line will begin on or after the 17th day of April, 2023 and will be completed within 120 days of the date of approval.

Firm Etex Telephone Coop., Inc.
By JASON ALLEN
Title PLANT ENGINEER
Address P.O. Box 130 Gilmer, TX 75644

- NOTE: 1. This form to be submitted in triplicate for each proposed installation.
2. The permit shall be in effect until the utility line is removed from the right of way.
3. Inform the County Engineer if work is not completed within this time

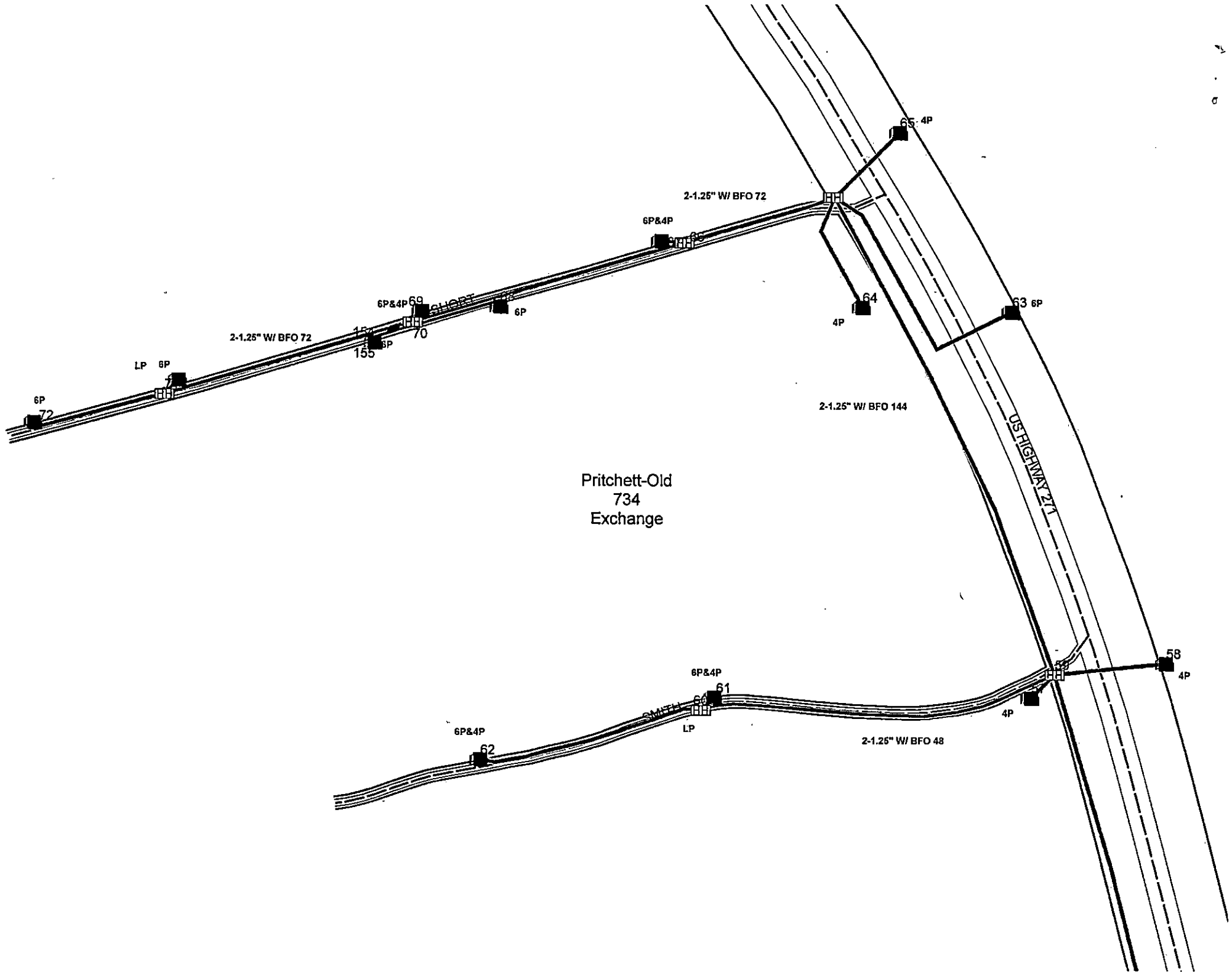

Chris Hood
First Party Signature

5045 TX-37
Street or Box

Clarksville, TX 75426
City, State and Zip Code

903-737-7133
Telephone

Laura E Siciliano
Timber Tract / Property Owner

Issued by Amanda Sullivan Valid March 11, 2026 to June 11, 2026

PERMIT ISSUED NOT TO EXCEED 90 DAYS UNLESS OTHERWISE NOTED

COPY OF THIS PERMIT MUST BE IN EVERY TRUCK BEING USED

*****A TEMPORARY CULVERT MUST BE INSTALLED IN DITCH BEING
USED FOR ACCESS TO LAND*****



First Party Signature

5273 Aspen Trail

Street or Box

Gilmer, TX 75645

City, State and Zip Code

903-720-5280

Telephone

Timber Tract / Property Owner

Issued by Amanda Sullivan Valid March 16, 2026 to June 16, 2026

PERMIT ISSUED NOT TO EXCEED 90 DAYS UNLESS OTHERWISE NOTED

COPY OF THIS PERMIT MUST BE IN EVERY TRUCK BEING USED

*****A TEMPORARY CULVERT MUST BE INSTALLED IN DITCH BEING
USED FOR ACCESS TO LAND*****

NOTICE OF PROPOSED INSTALLATION
PIPE AND/OR UTILITY LINES

DATE: 03/13/2026

TO: UPSHUR COUNTY COMMISSIONERS COURT
c/o UPSHUR COUNTY ENGINEER
UPSHUR COUNTY ROAD & BRIDGE DEPARTMENT
P. O. BOX 730
Gilmer, TX 75644

EXPIRES: 07/01/2026

Formal notice is hereby given that Etex Telephone Coop., Inc. proposes to bore a New Fiber Optic line within the right-of-way of County Roads pelican, welch, pheasant, carric, meadow, bob davis, and mountain view., as follows: Installing new fiber and duct on both sides of said county roads. All construction will be directionally bored at a min depth of 60" within the Upshur county Road and Bridge right-of-way.

The location and description of the proposed line and appurtenances is more fully shown by three copies of drawings attached to this notice. The line will be constructed and maintained on the County right-of-way as directed by the County Engineer in accordance with current Upshur County specifications.

Construction of this line will begin on or after the 30th day of march 2026 and will be completed within 120 days of the date of approval.

Firm Etex Telephone Coop., Inc.
By Jason allen
Title plant engineer
Address P.O. Box 130 Gilmer, TX 75644

- NOTE:
1. This form to be submitted in triplicate for each proposed installation.
 2. The permit shall be in effect until the utility line is removed from the right of way.
 3. Inform the County Engineer if work is not completed within this time

APPROVAL

TO: Etex Telephone Coop., Inc.
P.O. Box 130 Gilmer, TX 75644

DATE 03/13/2026

The Upshur County Commissioners Court offers no objections to the location on the right-of-way of your proposed New Fiber Optic line across pelican rd, welch rd, pheasant rd, carrier d, meadow rd, bob davis rd and mountain view rd., as shown by accompanying drawings and notice dated Approved, except as noted below:

N/A

It is expressly understood that the Upshur County Commissioners Court does not purport, hereby, to grant and right, claim, title, or easement in or upon this county road; and it is further understood that in the future should for any reason Upshur County need to work, improve, relocate, widen, increase add to or any manner change the structure of this right-of-way line, this line, if affected, will be moved under the direction of the Upshur County Engineer and shall be relocated at the complete expense of the owner. Upshur County shall be notified a minimum of 48 hours prior to the beginning of any work.

All work on the county right-of-way shall be performed in accordance with the County Engineer's instructions. The installation shall not damage any part of the highway and adequate provisions must be made to cause minimum inconvenience to traffic and adjacent property owners. Special specifications for placing this line are as follows:

1. All ground lines are to be installed a minimum of 36 inches below the flowline of the adjacent drainage or borrow ditch.
2. All excavations within the right-of-way and not under surfacing shall be backfilled by tamping in 6 inch horizontal layers. All surplus material shall be removed from the right-of-way and the excavation finished flush with surrounding natural ground.
3. Lines crossing under surfaced roads and under surfaced cross roads within the right-of-way shall be placed by boring. Boring shall extend from crown line to crown line.
4. All lines under roads carrying pressure in excess of 50 psi shall be enclosed in satisfactory casing extending from right-of-way line to right-of-way line. Pipe used for casing may be of any type approved by the County Engineer and shall be capable of Supporting the load of roadbed and traffic and shall be so constructed that there will be no leakage of any matter through the casing for its entire length. Inside diameter of casing shall be at least 2 inches greater than the largest outside diameter of carrier pipe, joint or couplings. (Encasement is not required on lines installed 48 inches or greater below flowline.)
5. All lines, where practicable, shall be located to cross roadbed at approximately right angles thereto. No lines are to be installed under or within 50 feet of either end of a bridge unless approved by the County Engineer in writing. No lines shall be placed inside any culvert or within 10 feet of the closest point of same.
6. Parallel lines will be installed as near the right-of-way lines as is possible and no parallel line will be installed in the roadbed or between the drainage ditch and roadbed unless approved by the County Engineer in writing.
7. Overhead lines will have a minimum clearance of 18 feet above the road surface at point of crossing.
8. Operations along roadways shall be performed in such a manner that all excavated material be kept off the pavements at all times, as well as all operating equipment and materials. Do not use equipment or installation procedures which will damage any road surface or structure. The cost of any repairs to road surfaces, roadbed, structures or other right-of-way features as direct result of this installation will be borne by the owner of this line.
9. Barricades, warning signs, lights and flagmen, when necessary, shall be provided by the contractor or owner. One half of the traveled portion of the road must be open to traffic at all times. All traffic control shall be in accordance with the requirements of the current version of the Texas MUTCD.
10. Utility company shall install adequate erosion control measures for any excavation work being performed.

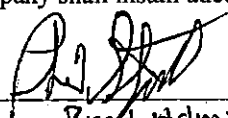
APPROVED: 
Road Administrator

APPROVED: _____
Chairperson, Upshur County Commissioners Court

NOTICE OF PROPOSED INSTALLATION

LM 729

WELCH

PELICAN

SHIL 1228

PHIABANE

Pritchett-Old
734
Exchange

MEADOW

CARRIE

ROB DAVIS

MOUNTAIN

BDB-O-LINK

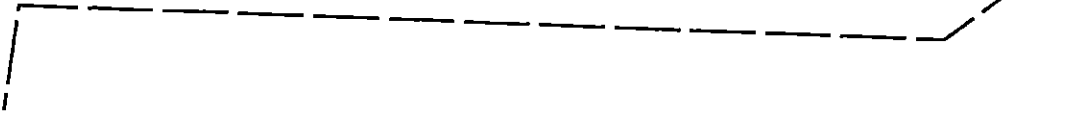

APPROVAL

TO: Etex Telephone Coop., Inc.
P.O. Box 130 Gilmer, TX 75644

DATE 03/11/2026

The Upshur County Commissioners Court offers no objections to the location on the right-of-way of your proposed New Fiber Optic line ON BOTH SIDES OF REDWOOD RD FROM HWY 271 FOR APPX. 4000 FT., as shown by accompanying drawings and notice dated Approved, except as noted below:

N/A

It is expressly understood that the Upshur County Commissioners Court does not purport, hereby, to grant and right, claim, title, or easement in or upon this county road; and it is further understood that in the future should for any reason Upshur County need to work, improve, relocate, widen, increase add to or any manner change the structure of this right-of-way line, this line, if affected, will be moved under the direction of the Upshur County Engineer and shall be relocated at the complete expense of the owner. Upshur County shall be notified a minimum of 48 hours prior to the beginning of any work.

All work on the county right-of-way shall be performed in accordance with the County Engineer's instructions. The installation shall not damage any part of the highway and adequate provisions must be made to cause minimum inconvenience to traffic and adjacent property owners. Special specifications for placing this line are as follows:

1. All ground lines are to be installed a minimum of 36 inches below the flowline of the adjacent drainage or borrow ditch.
2. All excavations within the right-of-way and not under surfacing shall be backfilled by tamping in 6 inch horizontal layers. All surplus material shall be removed from the right-of-way and the excavation finished flush with surrounding natural ground.
3. Lines crossing under surfaced roads and under surfaced cross roads within the right-of-way shall be placed by boring. Boring shall extend from crown line to crown line.
4. All lines under roads carrying pressure in excess of 50 psi shall be enclosed in satisfactory casing extending from right-of-way line to right-of-way line. Pipe used for casing may be of any type approved by the County Engineer and shall be capable of Supporting the load of roadbed and traffic and shall be so constructed that there will be no leakage of any matter through the casing for its entire length. Inside diameter of casing shall be at least 2 inches greater than the largest outside diameter of carrier pipe, joint or couplings. (Encasement is not required on lines installed 48 inches or greater below flowline.)
5. All lines, where practicable, shall be located to cross roadbed at approximately right angles thereto. No lines are to be installed under or within 50 feet of either end of a bridge unless approved by the County Engineer in writing. No lines shall be placed inside any culvert or within 10 feet of the closest point of same.
6. Parallel lines will be installed as near the right-of-way lines as is possible and no parallel line will be installed in the roadbed or between the drainage ditch and roadbed unless approved by the County Engineer in writing.
7. Overhead lines will have a minimum clearance of 18 feet above the road surface at point of crossing.
8. Operations along roadways shall be performed in such a manner that all excavated material be kept off the pavements at all times, as well as all operating equipment and materials. Do not use equipment or installation procedures which will damage any road surface or structure. The cost of any repairs to road surfaces, roadbed, structures or other right-of-way features as direct result of this installation will be borne by the owner of this line.
9. Barricades, warning signs, lights and flagmen, when necessary, shall be provided by the contractor or owner. One half of the traveled portion of the road must be open to traffic at all times. All traffic control shall be in accordance with the requirements of the current version of the Texas MUTCD.
10. Utility company shall install adequate erosion control measures for any excavation work being performed.

APPROVED: 
Road Administrator

APPROVED: _____
Chairperson, Upshur County Commissioners Court

NOTICE OF PROPOSED INSTALLATION

NOTICE OF PROPOSED INSTALLATION
PIPE AND/OR UTILITY LINES

DATE: 03/11/2026

TO: UPSHUR COUNTY COMMISSIONERS COURT
c/o UPSHUR COUNTY ENGINEER
UPSHUR COUNTY ROAD & BRIDGE DEPARTMENT
P. O. BOX 730
Gilmer, TX 75644

EXPIRES: 07/01/2026

Formal notice is hereby given that Etex Telephone Coop., Inc. proposes to bore a New Fiber Optic line within the right-of-way of County Roads REDWOOD ROAD, as follows: Installing new fiber and duct on both sides of said county roads. All construction will be directionally bored at a min depth of 60" within the Upshur county Road and Bridge right-of-way.

The location and description of the proposed line and appurtenances is more fully shown by three copies of drawings attached to this notice. The line will be constructed and maintained on the County right-of-way as directed by the County Engineer in accordance with current Upshur County specifications.

Construction of this line will begin on or after the 23rd day of MARCH, 2026 and will be completed within 120 days of the date of approval.

Firm Etex Telephone Coop., Inc.
By JASON ALLEN
Title PLANT ENGINEER
Address P.O. Box 130 Gilmer, TX 75644

- NOTE: 1. This form to be submitted in triplicate for each proposed installation.
2. The permit shall be in effect until the utility line is removed from the right of way.
3. Inform the County Engineer if work is not completed within this time

